

COMUNE DI POGGIOMARINO
CITTÀ METROPOLITANA DI NAPOLI

INTERVENTI IN MATERIA DI MOBILITÀ SOSTENIBILE ED EFFICIENTAMENTO ENERGETICO DI VIA SISCARA E PARTE DI VIA FONTANELLE

Progetto di fattibilità tecnica - Forme di finanziamento

COMITTEE
COMITTEE DI POGGIOMARINO



OGGETTO	INTERVENTI IN MATERIA DI MOBILITÀ SOSTENIBILE ED EFFICIENTAMENTO ENERGETICO DI VIA SISCARA E PARTE DI VIA FONTANELLE	RESPONSABILI TECNICI	ING. GIUSEPPE DEL SOBBRO
TAV	UNICA	PROGETTISTA	ING. DEBORA SORRENTINO
Scale 1:1000	- Strada esistente - Arredo	COLLABORATORI A CARICO	ING. RAFFAELE SORRENTINO ING. MARIO PADOVANO
Scale 1:200	- Pianimetria con filari di progetto	SECCIONE A-A' DI PROGETTO	ING. STEFANIA DANINO
Scale 1:20	- Particolari costruttivi - Coni edici e filo	ING. FRANCESCO BELLOCCHIO	ING. FRANCESCO BELLOCCHIO

PLANIMETRIA PRIMO TRATTO VIA SISCARA - Scala 1:200

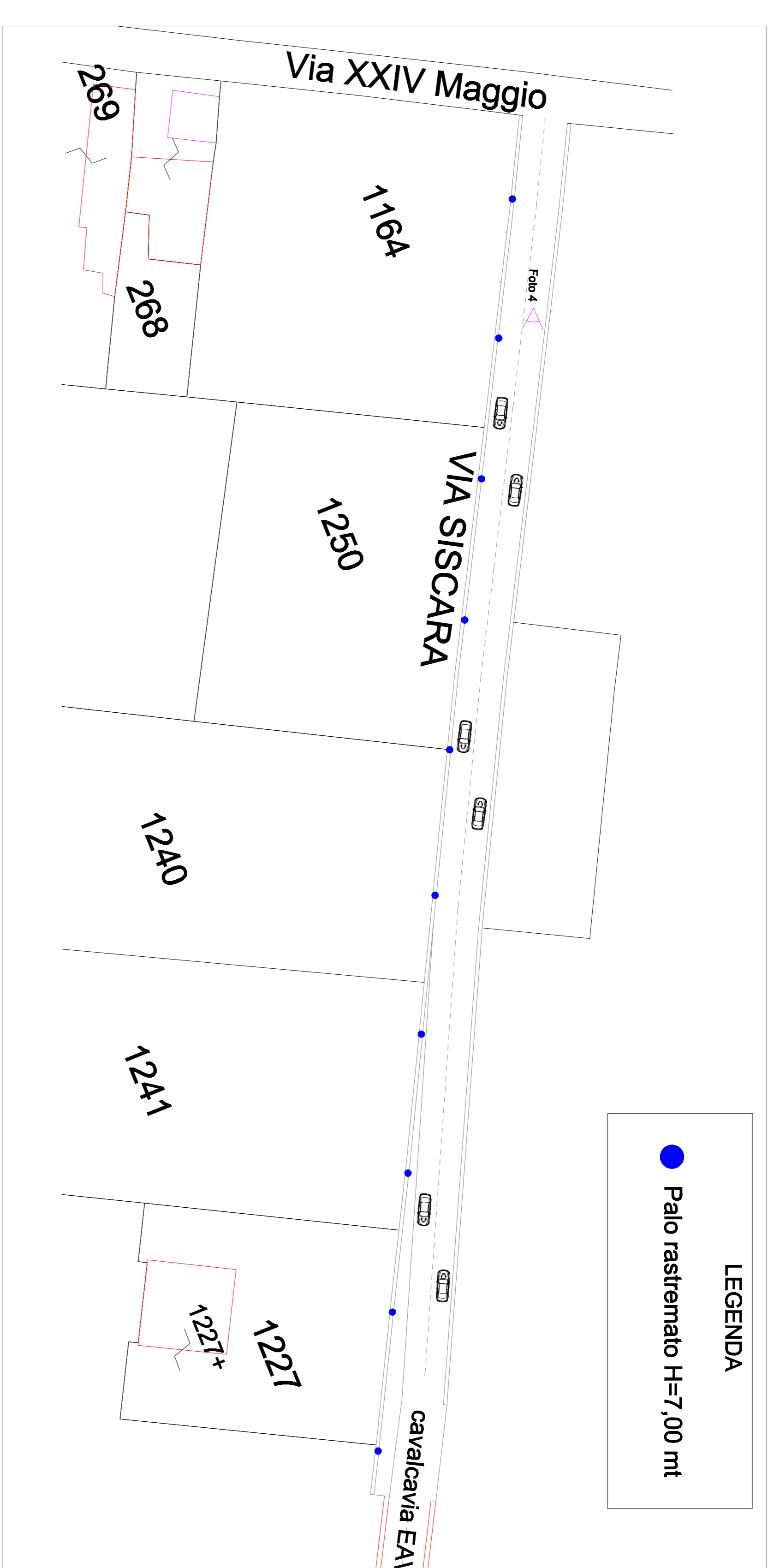

PLANIMETRIA SECONDO TRATTO VIA SISCARA - Scala 1:200



STRALCIO DEL PRG



Foto 1



Foto 2

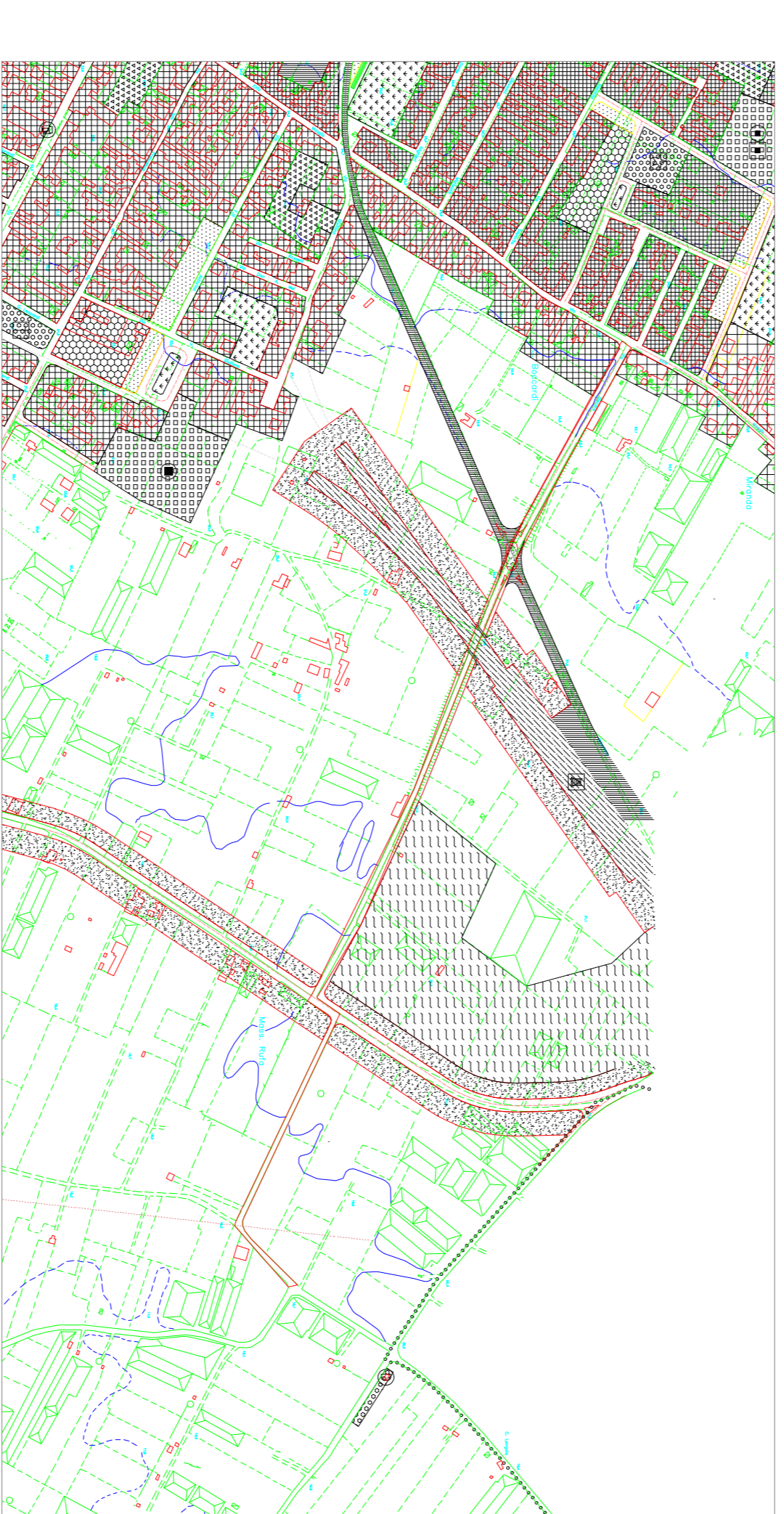

Foto 3



Foto 4



Foto 5



Foto 6



Foto 7

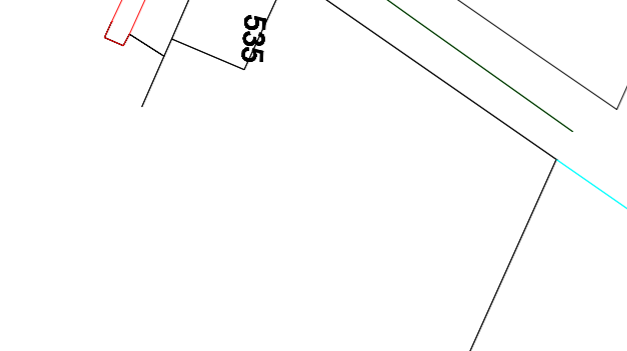

Foto 8

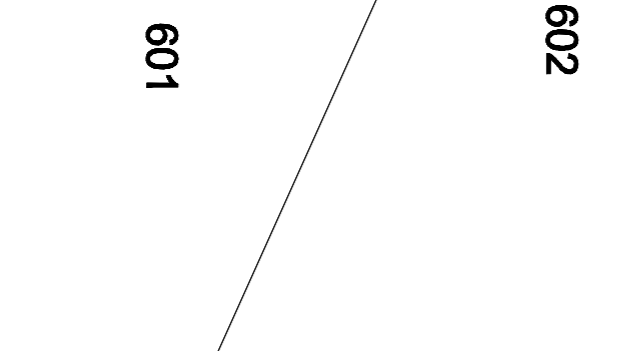

Foto 9

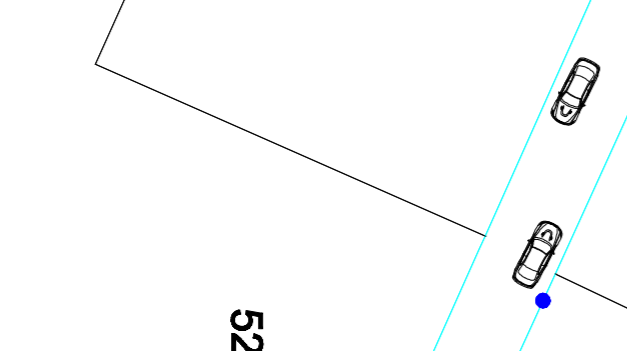

Foto 10

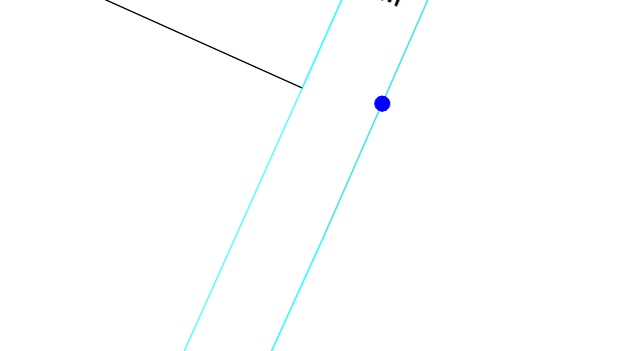

Foto 11

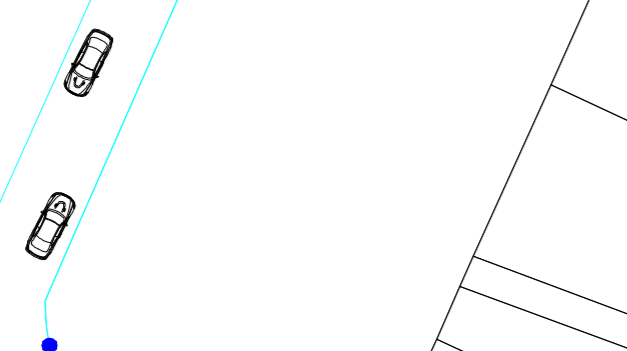

Foto 12

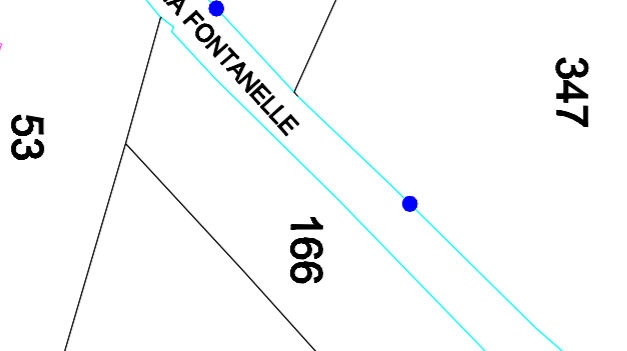

Foto 13

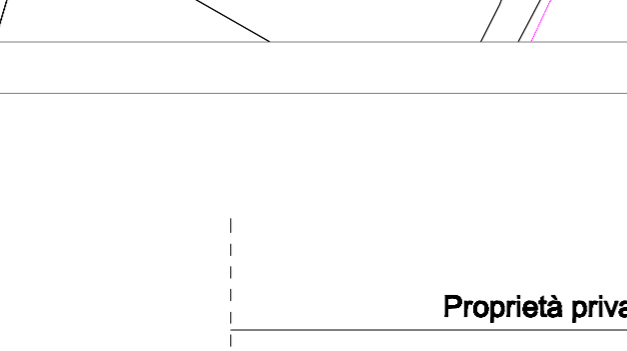

Foto 14

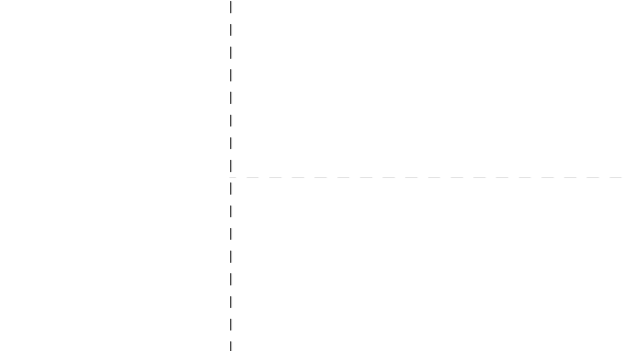

Foto 15

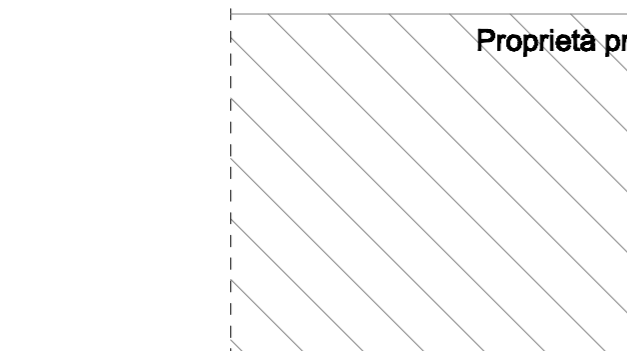

Foto 16

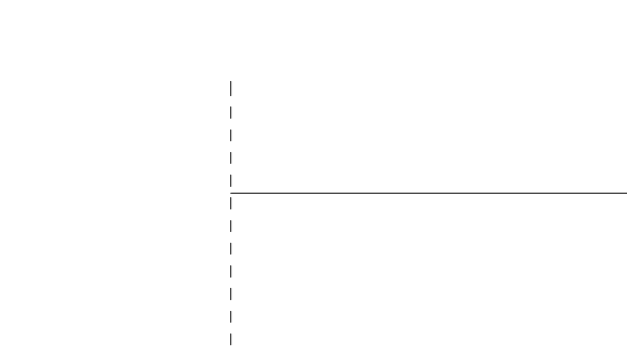

Foto 17

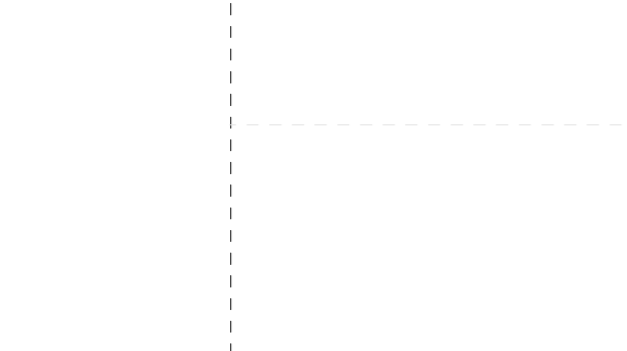

Foto 18

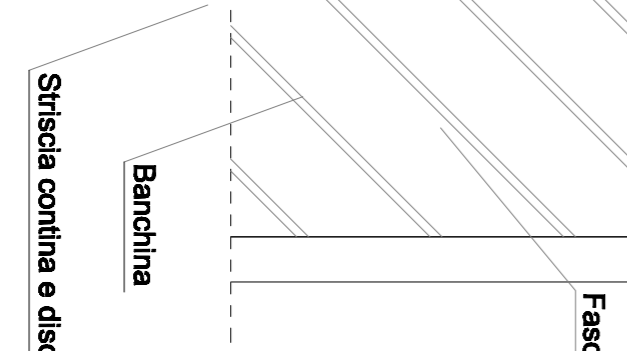

Foto 19

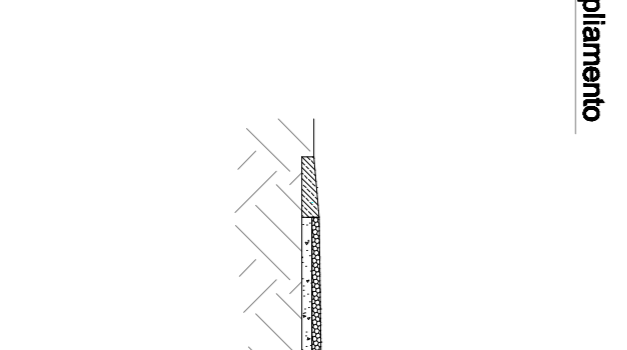

Foto 20

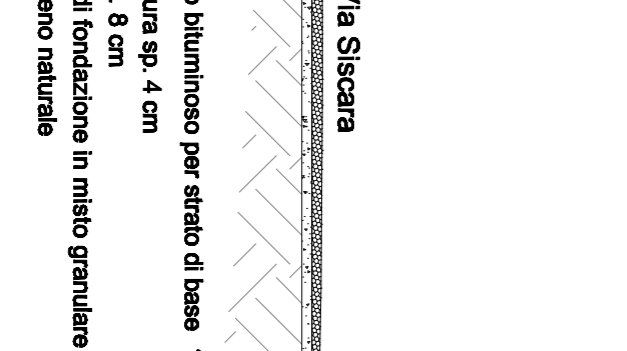

Foto 21

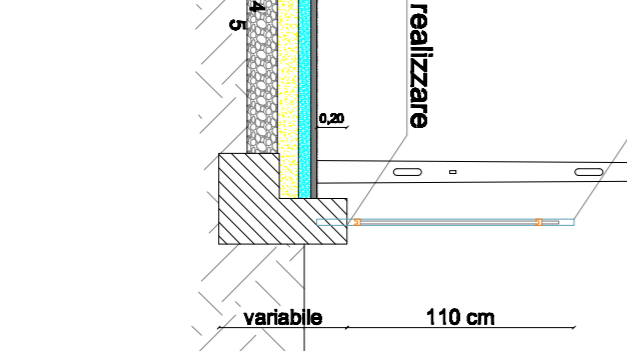

Foto 22



PIANTA E SEZIONI - Scala 1:20

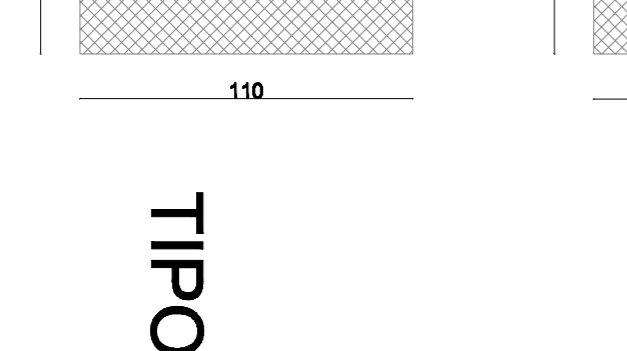
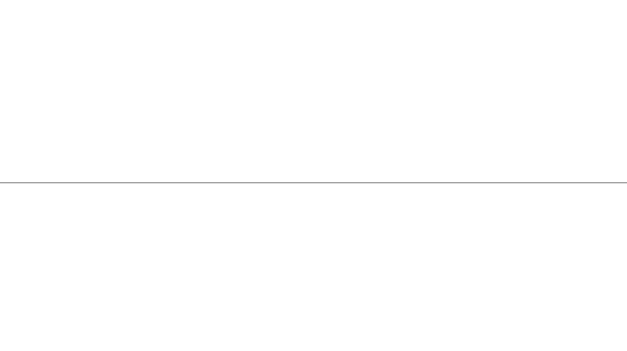
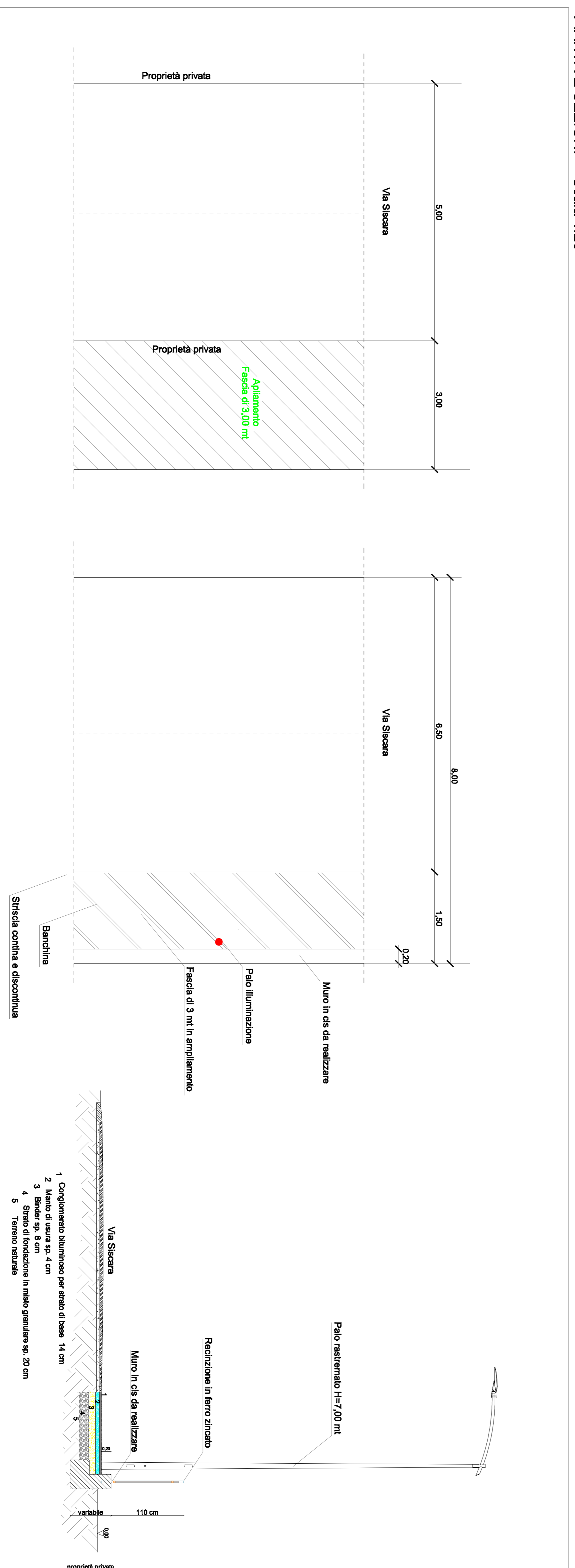

MURETTI DA REALIZZARE
Tipologie murarie

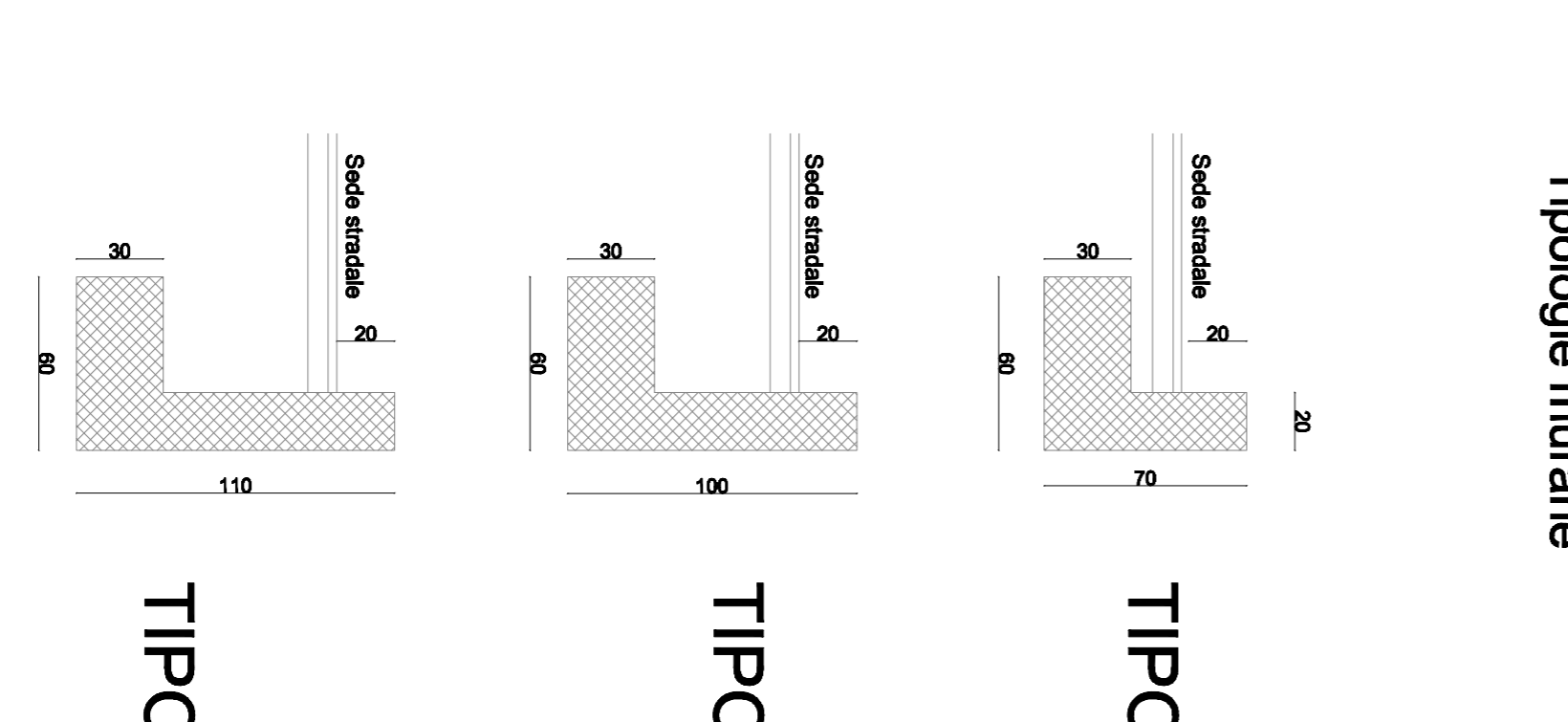

PIANTA STATO DI FATTO

PIANTA STATO DI PROGETTO

SEZIONE A-A' STATO DI PROGETTO

LEGENDA: TRATTO DI STRADA INTERESSATA DAI LAVORI